

Detalhamento da instalação das placas

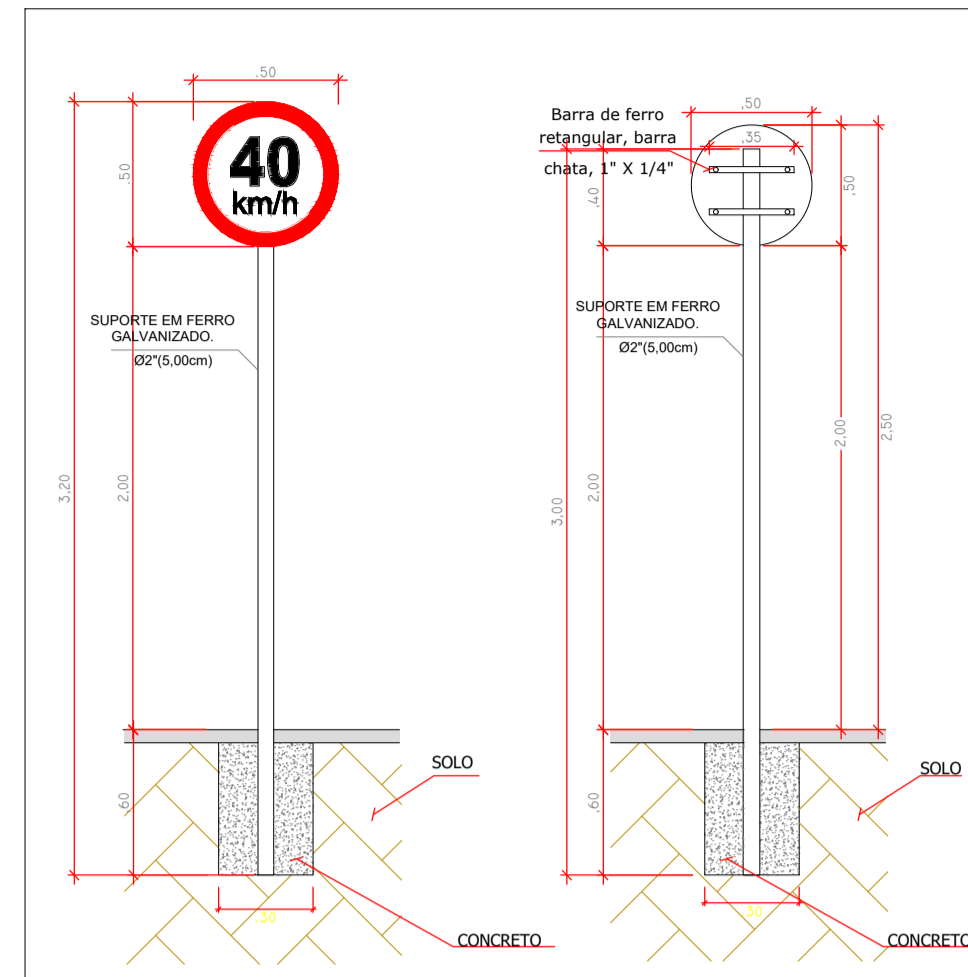

R-19; Velocidade máxima permitida 40km/h

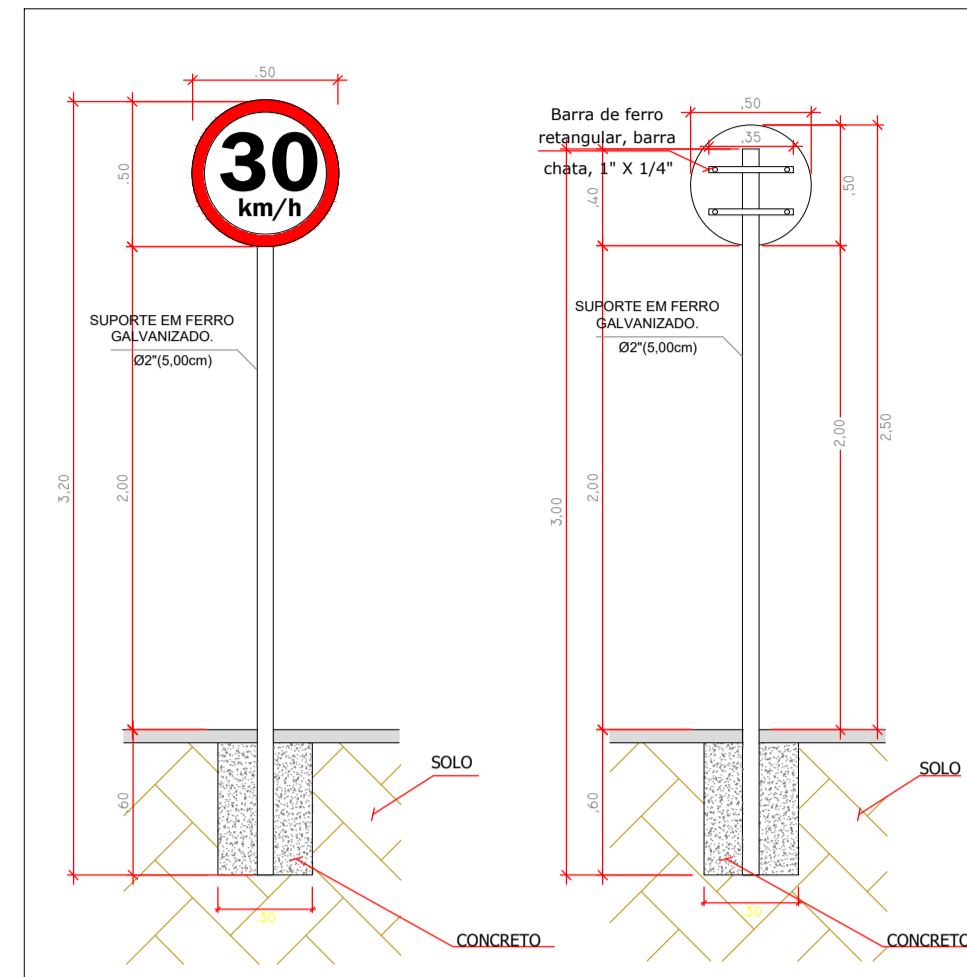

R-19; Velocidade máxima permitida 30km/h

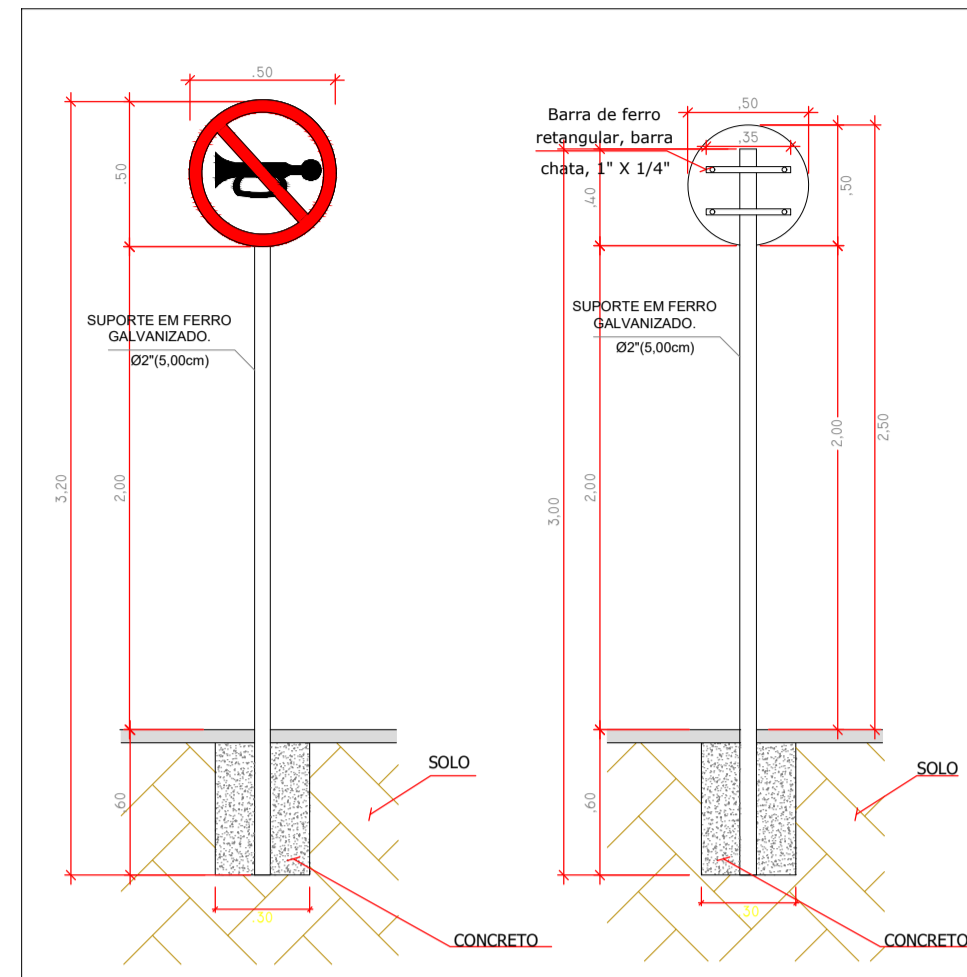

R-20; Proibido acionar buzina

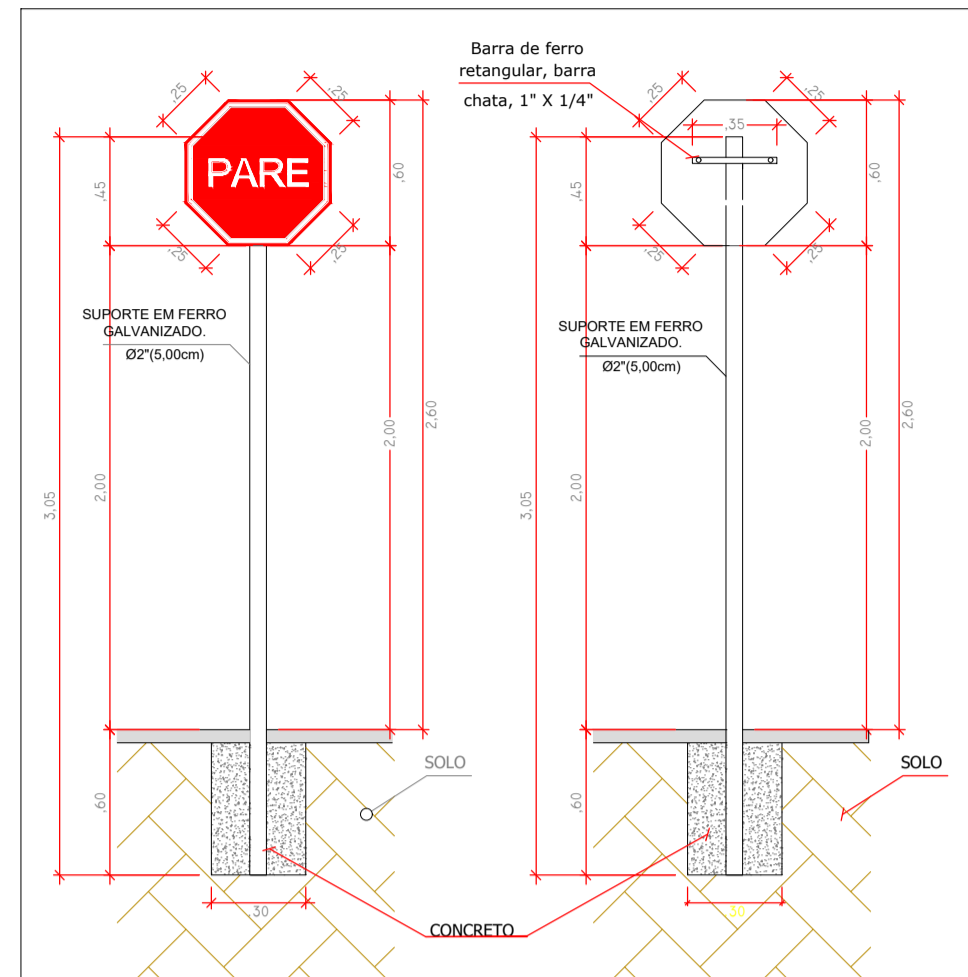

R-1; Parada obrigatória

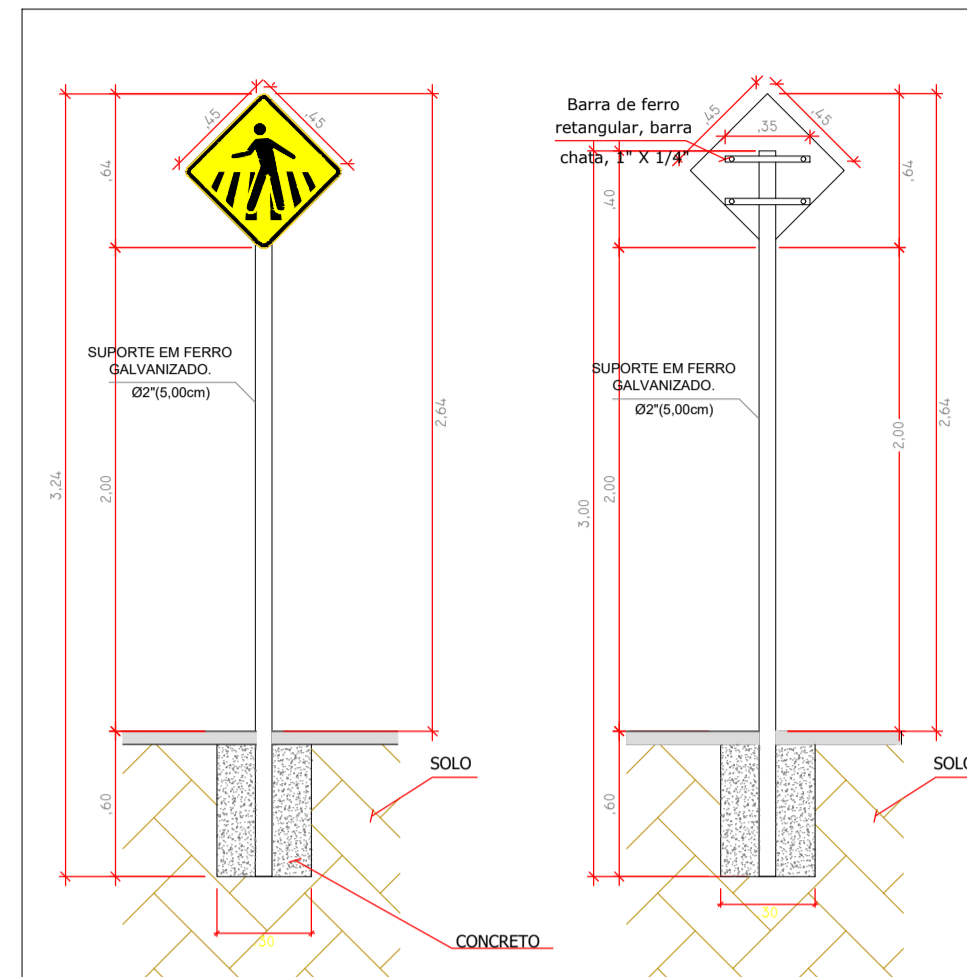

A32-b e A32-a; Passagem sinalizada de pedestres.

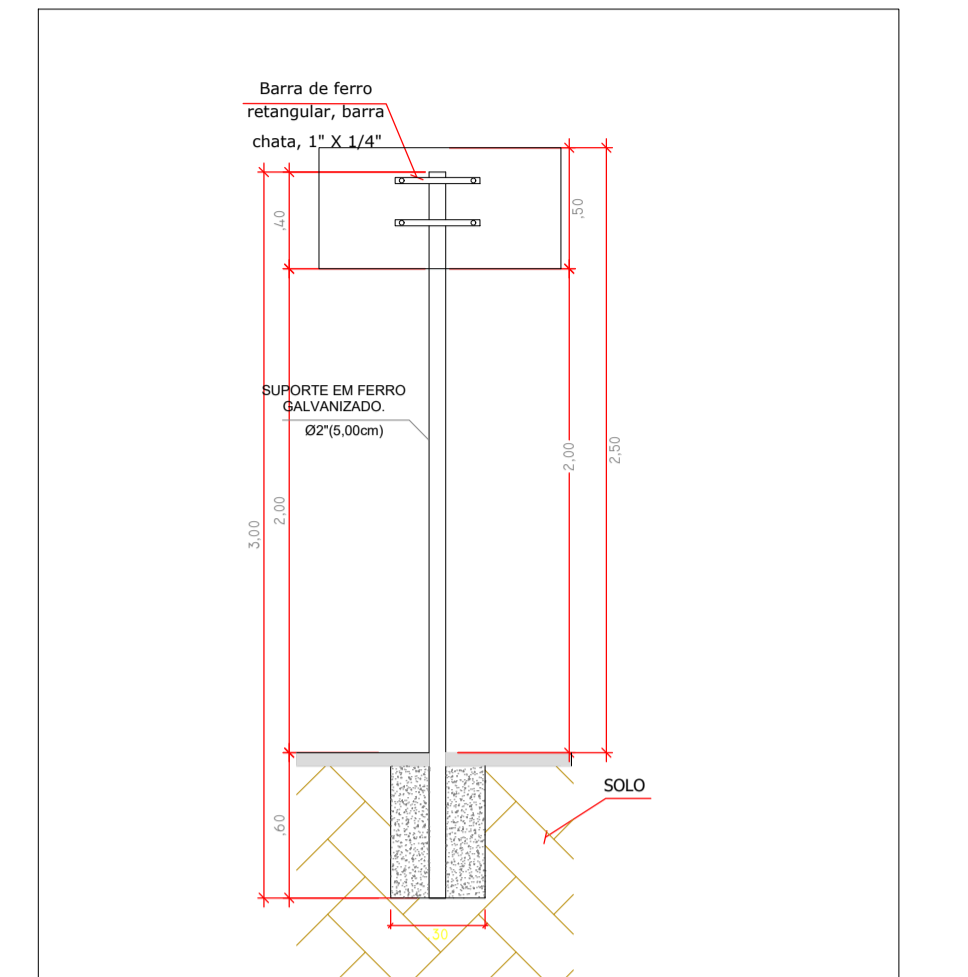

Placa de indicação de prédio publico

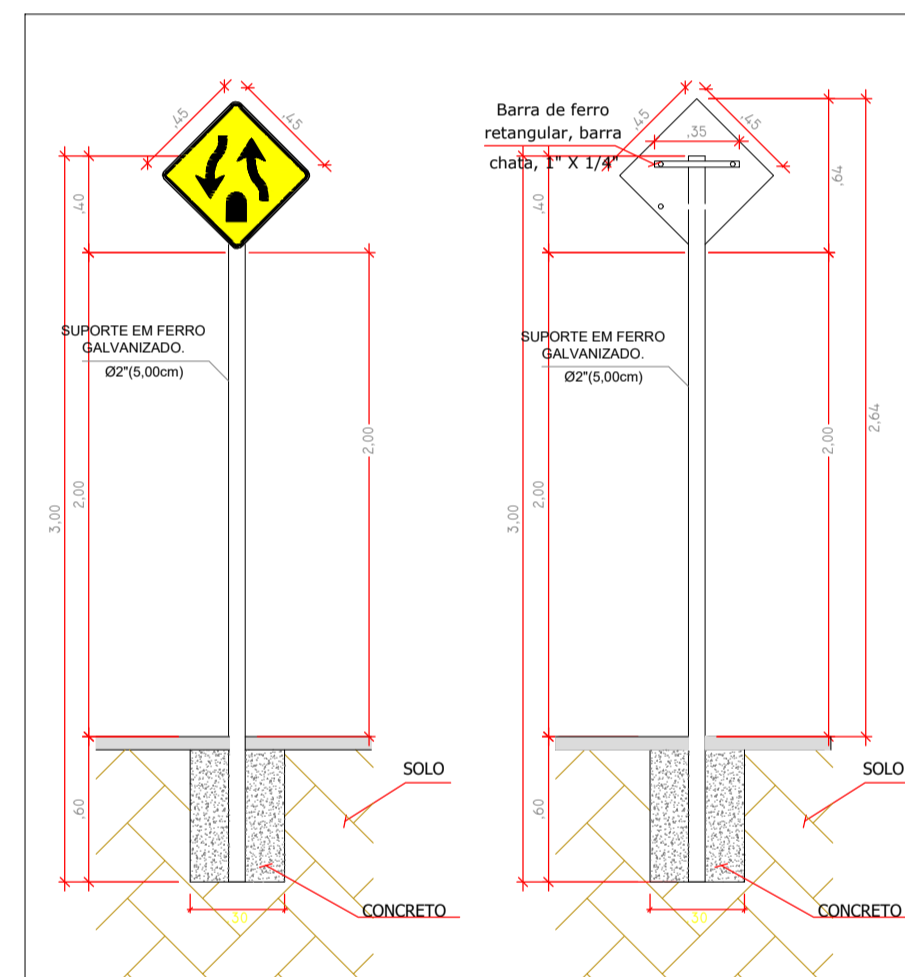

A-42b; Fim da pista dupla

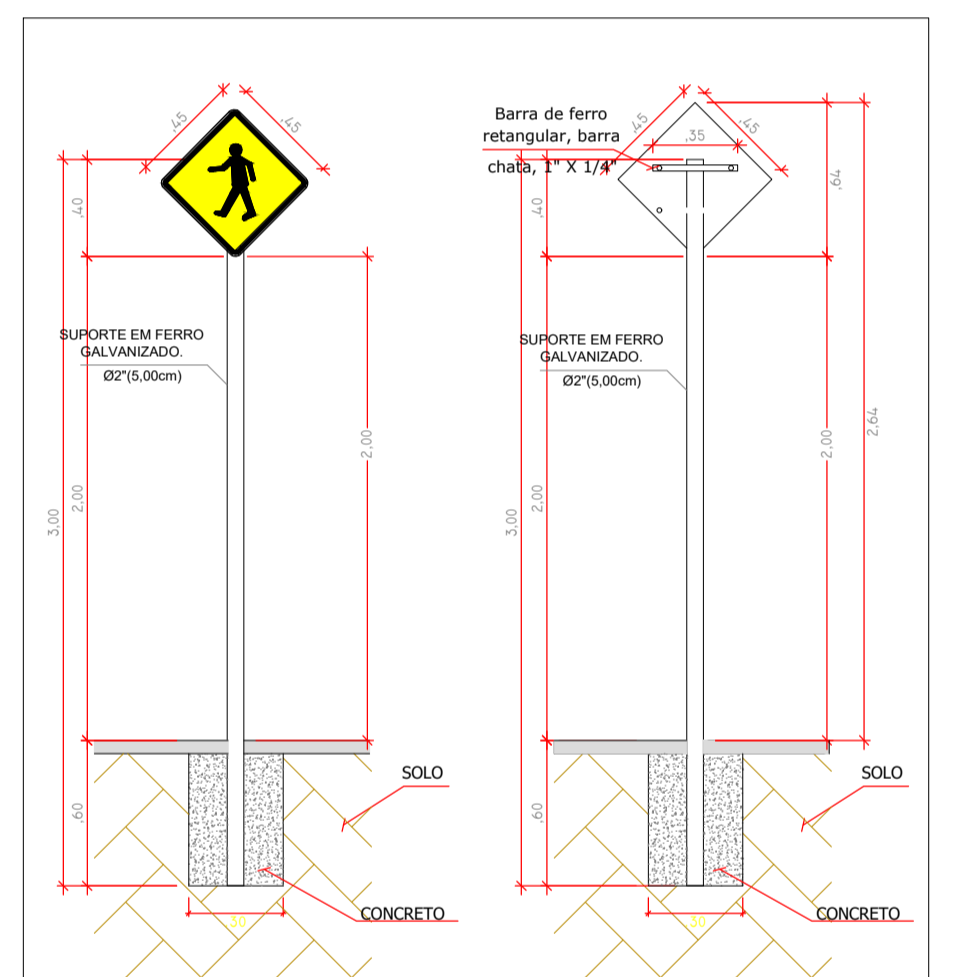

A32-a; Trânsito de pedestres

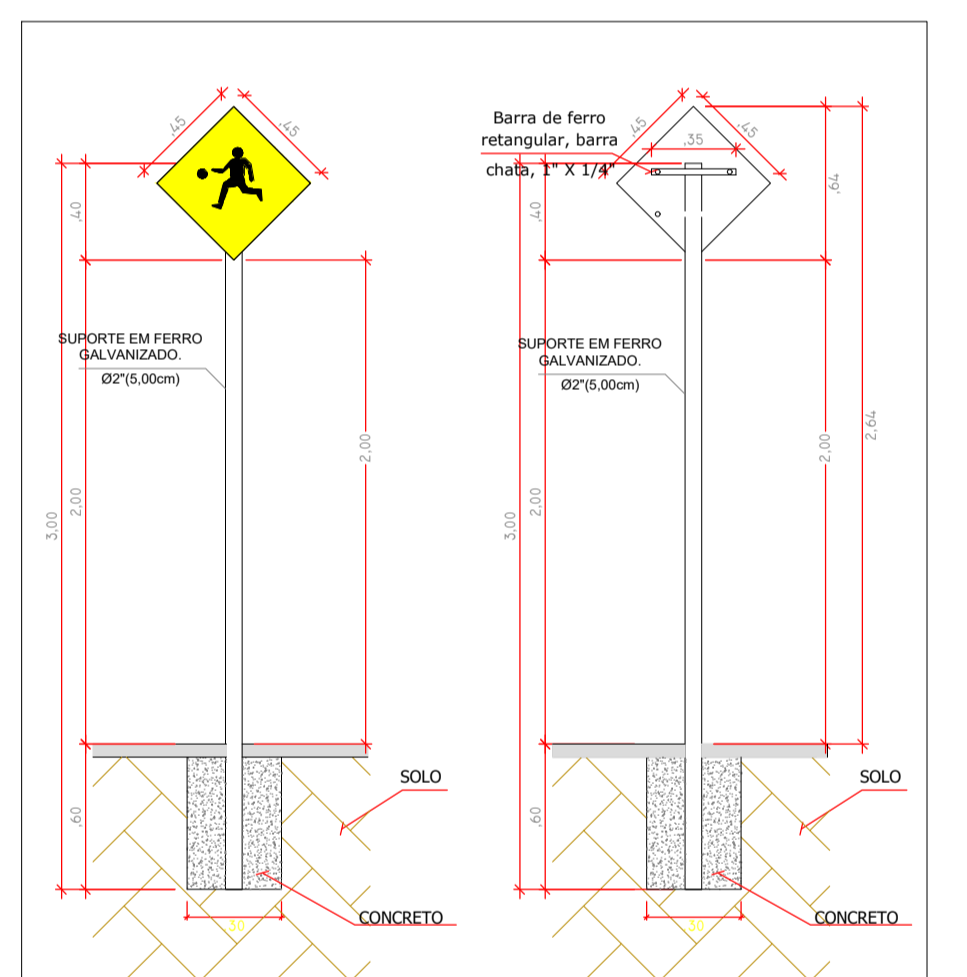

A-34; Crianças

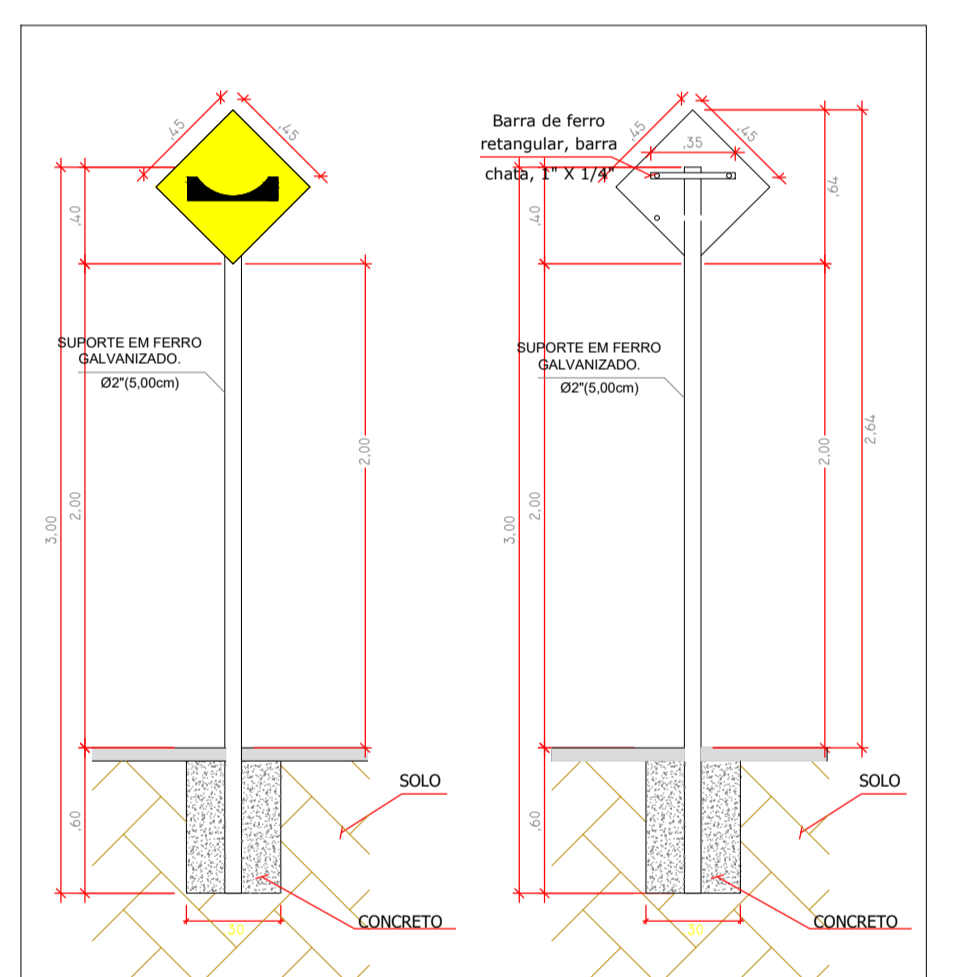

A19; Depressão

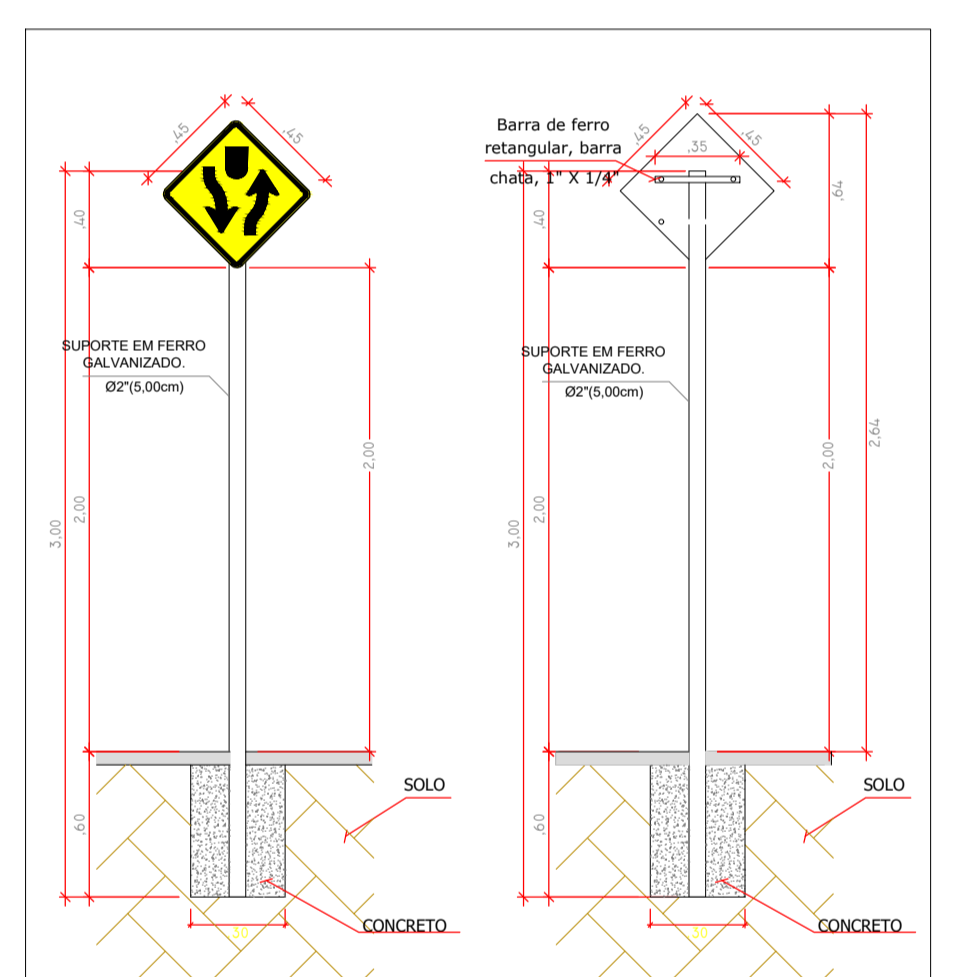

A42-a; Início de pista dupla

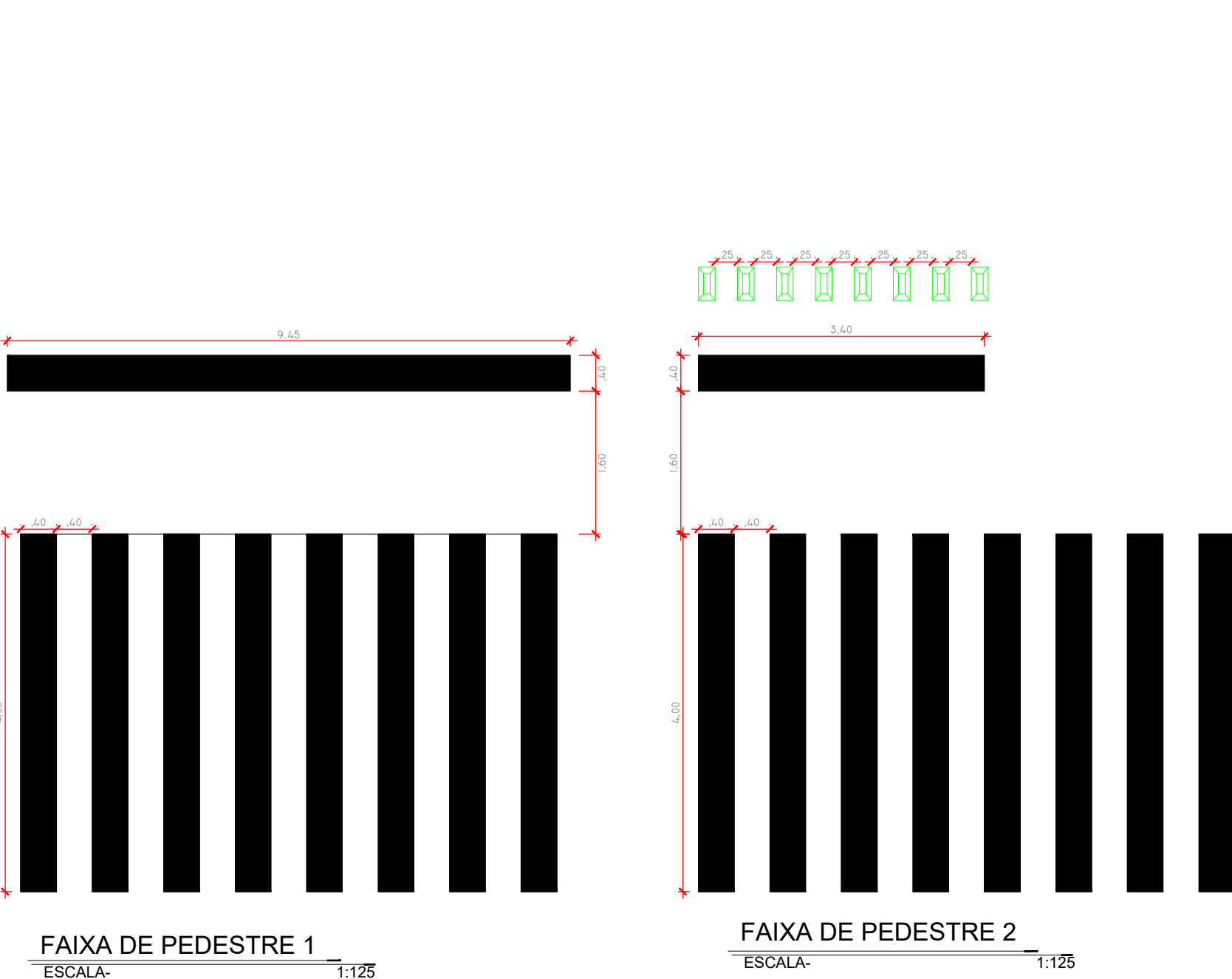
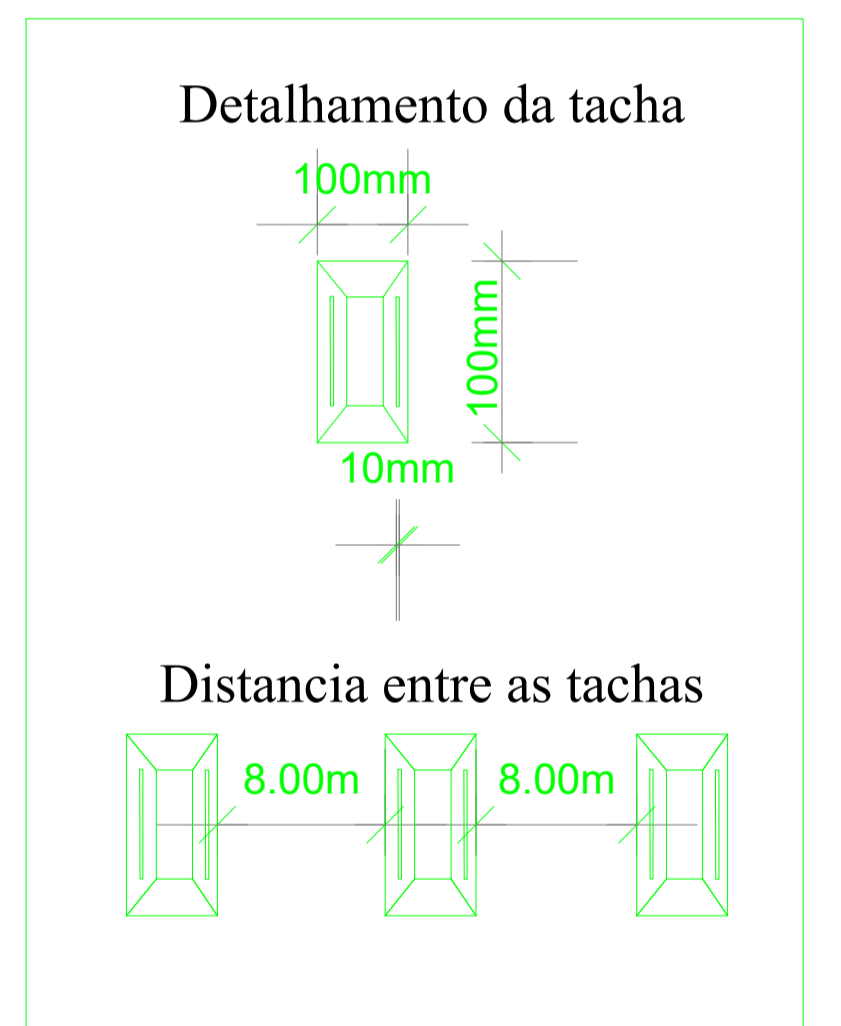

ANO	2022	TIPO	PROJETO EXECUTIVO SINALIZAÇÃO	ALTERAÇÕES:
				A- -
				B
				C
SINALIZAÇÃO URBANA VERTICAL E HORIZONTAL			ÁREAS (m²):	VER MEMORIAL
CONVENIENTE:	PREFEITURA MUNIC. DE VALE DO ANARI	LOCAL:	RUAS E AVENIDAS DA ÁREA URBANA	DATA
REQUERENTE:	PREFEITURA MUNIC. DE VALE DO ANARI			MAR,2022
V		FOLHA		DM
S		02/02		METRO
T				ESC
				INDIC.